

GTS INSTALLATION INSTRUCTION

CYLINDRICAL LOCK

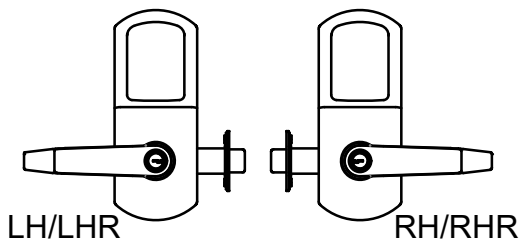

Phone: 866-874-3662 | www.pdqlocks.com



1. CHECK HANDING OF LOCK

- If handing of lock is not correct for opening, see next page for handing instructions.

2. PREPARE DOOR & INSTALL LATCH

- Prepare door according to template.
- Install latch, radius toward door frame
- Secure with (2) small combo screws.

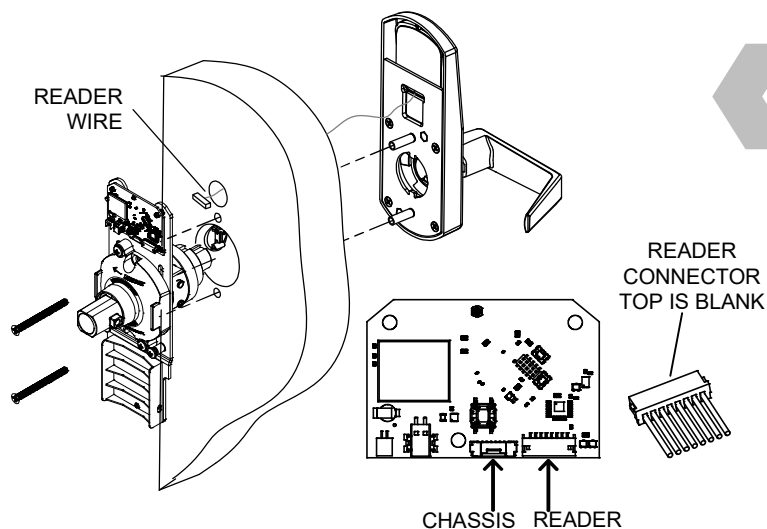
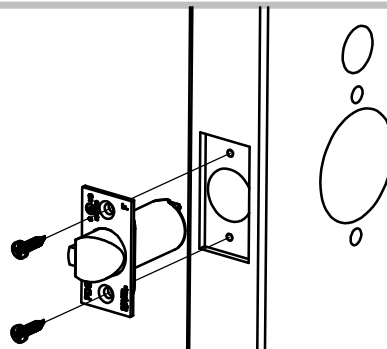

3. INSTALL CHASSIS AND OUTSIDE TRIM

- Remove inside escutcheon from backplate
- Install chassis assembly from inside of door.
- Install outside trim assembly – feed reader wire through hole and door and through slot under circuit board. Plug into board. Push extra wire into door cavity.
 - *Wire harness will land into wire pocket.*
 - *Refer to image for location.*
- Secure with (2) flat head screws (thru bolts).

4. INSTALL INSIDE ESCUTCHEON

- Install inside escutcheon.
- Secure with (2) pan head screws.

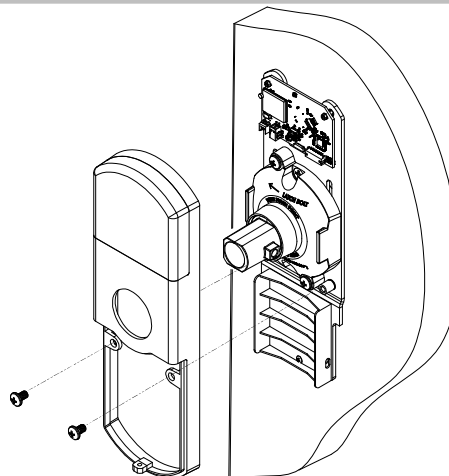

GTS INSTALLATION INSTRUCTION

CYLINDRICAL LOCK



Phone: 866-874-3662 | www.pdqlocks.com

5. INSTALL BATTERIES AND INSIDE LEVER

- Install batteries and battery cover with flat head screw.
- Install inside lever and secure with dog point set screw.
- **CAUTION: DO NOT CROSS THREAD**

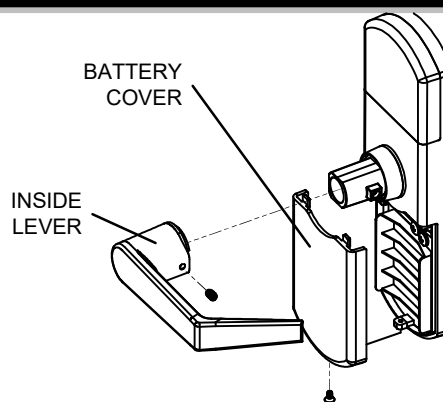

HANDING INSTRUCTIONS

AS REQUIRED, ROTATE INSIDE ROSE PLATE AND CHASSIS TO MATCH HAND OF DOOR.

TO ROTATE CHASSIS:

1. Remove rose plate mounting screws, then rose plate.
2. Unplug motor connector. Feed motor connector and wire back through wire chase slot.
3. Rotate chassis 1/2 turn (180°) maximum.
4. Feed motor connector and wire forward through wire chase slot on other side. Re-connect motor connector.
5. Rotate rose plate to index with chassis. (Arrows point to latch bolt edge of door.)
6. Install rose plate, secure with mounting screws.

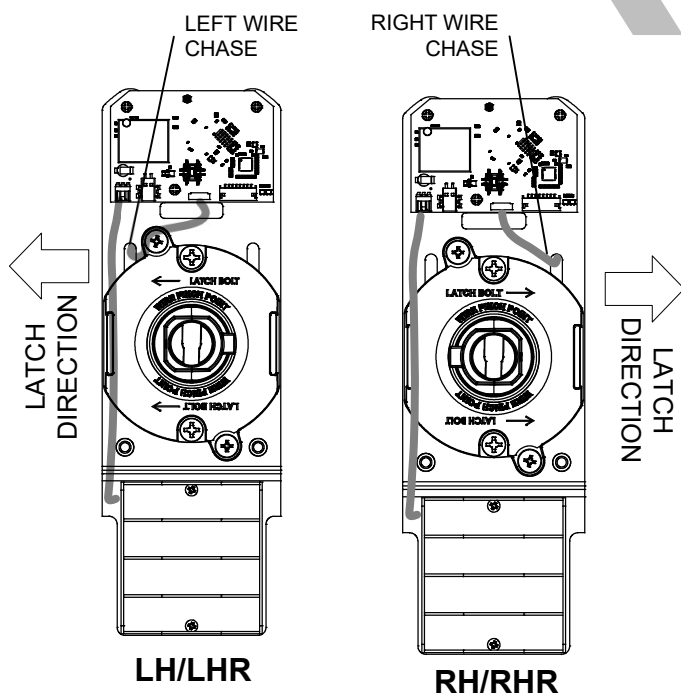

Scan the QR Code to
download the Spirit App.

