

# GTS INSTALLATION INSTRUCTION

## PASSIVEBOLT POWERED CYLINDRICAL LOCK



For Mechanical Concerns:  
Phone: 866-874-3662  
www.pdqlocks.com

**PassiveBolt**

For Electrical Concerns:  
Email: support@passivebolt.com  
www.PassiveBolt.com

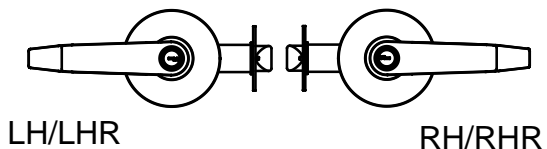

### 1. CHECK HANDING OF LOCK

- If handing of lock is not correct for opening, see next page for handing instructions.

### 2. PREPARE DOOR & INSTALL LATCH

- Prepare door according to template.
- Install latch, radius toward door frame
- Secure with (2) #8 combo screws.

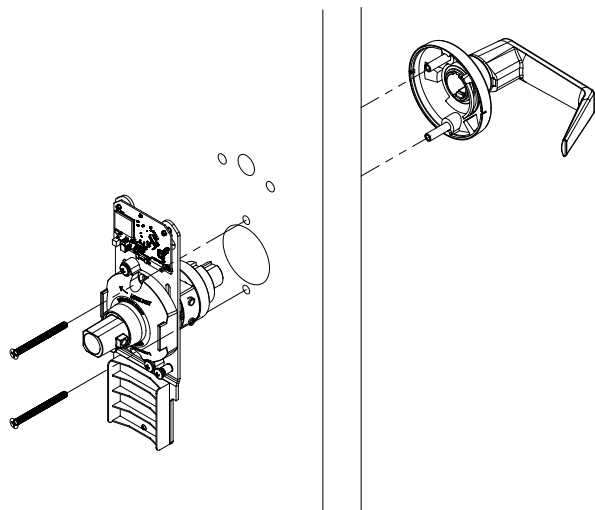
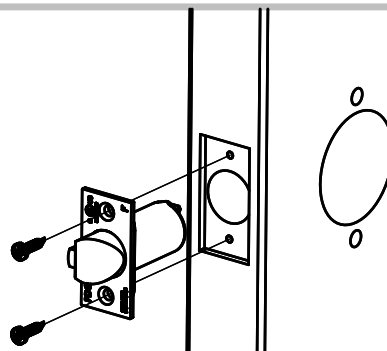

### 3. INSTALL CHASSIS AND OUTSIDE TRIM

- Install chassis assembly from inside of door.
- Install outside trim assembly.
- Secure with (2) flat head screws (thru bolts).

### 4. CAREFULLY REMOVE LOCK CONTROL MODULE (LCM)

- Disconnect battery connector from LCM
- Remove LCM by pulling board off standoffs
- Place removed LCM on a piece of cardboard

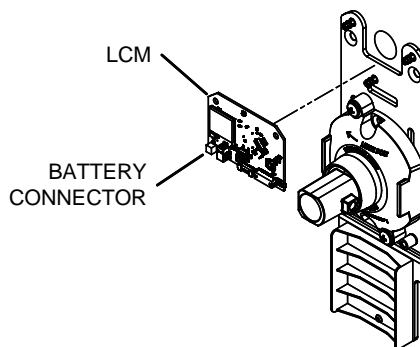

# GTS INSTALLATION INSTRUCTION



## 5. INSTALL READER ASSEMBLY

- Install housing from outside of door
- Route wires through door
- Do not pinch wires
- Secure with (2) flat head screws
- Reinstall LCM on backplate

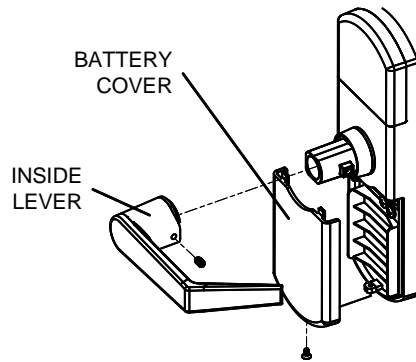
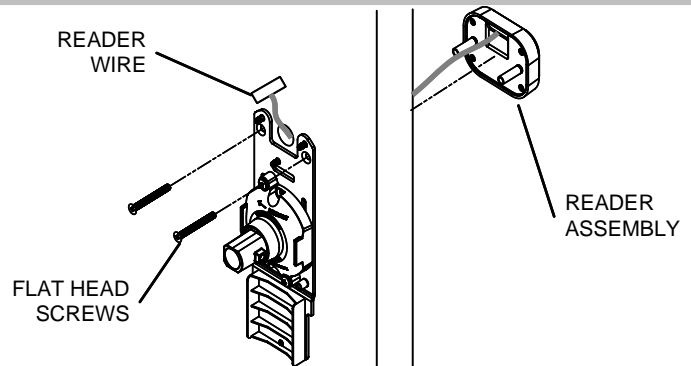

## 6. INSTALL INSIDE ESCUTCHEON, BATTERIES, AND COVER

- Install inside escutcheon.
- Secure with (2) pan head screws.
- Install batteries and battery cover with flat head screw.
- Install inside lever and secure with dog point set screw.

## HANDING INSTRUCTIONS

AS REQUIRED, ROTATE INSIDE ROSE PLATE AND CHASSIS TO MATCH HAND OF DOOR.

TO ROTATE CHASSIS:

1. Remove rose plate mounting screws, then rose plate.
2. Unplug motor connector. Feed motor connector and wire back through wire chase slot.
3. Rotate chassis 1/2 turn (180°) maximum.
4. Feed motor connector and wire forward through wire chase slot on other side. Re-connect motor connector.
5. Rotate rose plate to index with chassis. (Arrows point to latch bolt edge of door.)
6. Install rose plate, secure with mounting screws.

