

9300 SERIES MULLION INSTALLATION INSTRUCTIONS

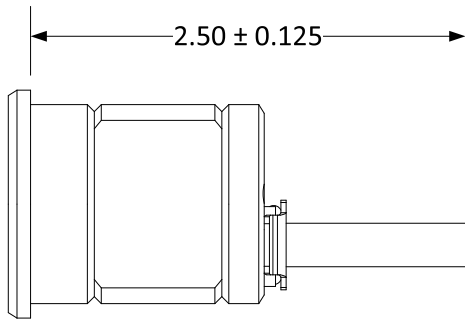

Phone: 833-2-PDQTEC | www.pdqlocks.com



1. FOR KEY REMOVABLE, CUT CYLINDER TAILPIECE

- Measure and adjust tailpiece
- Cylinder is sold separately

2. ASSEMBLE TOP BRACKET

- For Key removable, secure cylinder in faceplate with cylinder cup
- Secure faceplate in top bracket using (2) 1/4-20 x 5/8" FHMS
- Verify latch retracts by key
- For non-key removable. Verify latch retracts with screwdriver

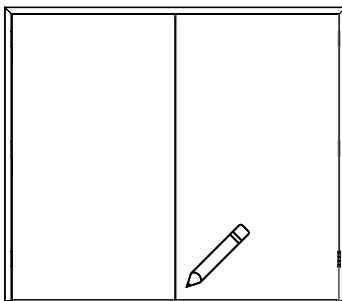
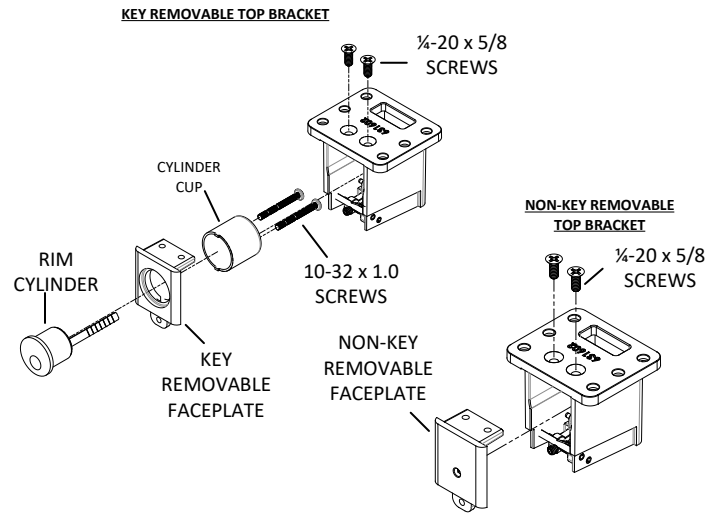

3. MARK CENTERS

- Mark center of opening on frame and floor

4. PREPARE FRAME

- Using provided shim as template, mark, drill, and tap (4) 5/16-18 holes
- Frame reinforcement is required

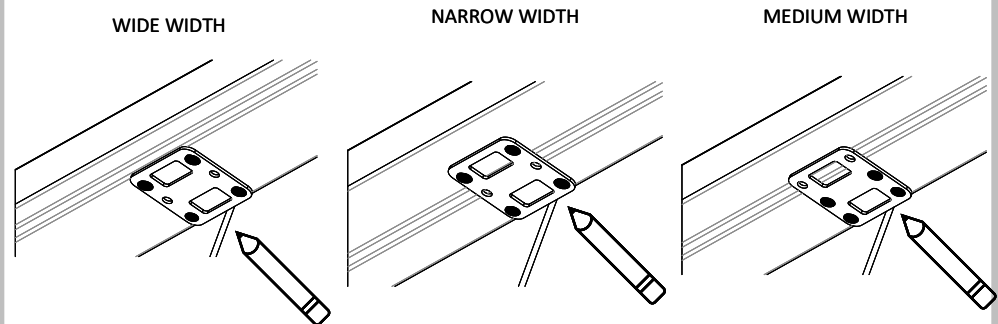

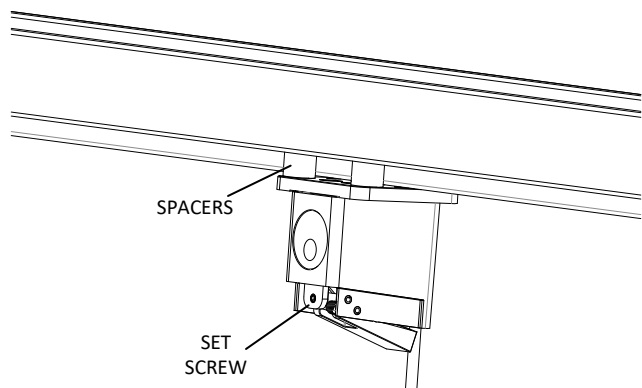

5. INSTALL TOP BRACKET

- For wide/medium frame, secure top bracket to frame using (4) 5/16-18 x 5/8" screws
- For narrow frame, add (2) 1/2" OR 5/8" spacers. Use 5/16-18 x 1 1/2" screw for each spacer
- Install set screw flush with faceplate

6. CUT MULLION TUBE

- H = Height of opening from frame stop to finished floor
- C = Cut length of mullion tube
- $C = H - 2 \frac{13}{16}"$
- If there is a threshold, cut it off so mullion and bottom bracket lay flat
- Install warning label near top of mullion

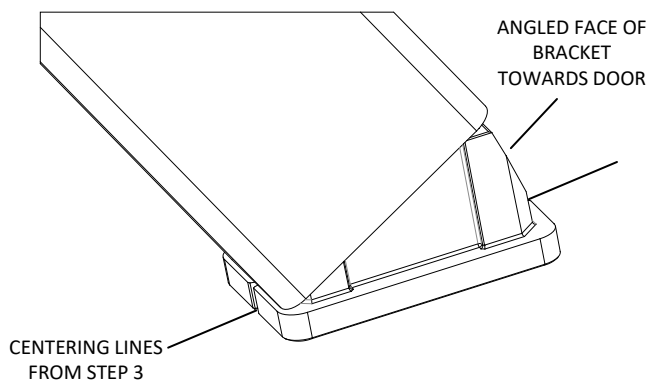
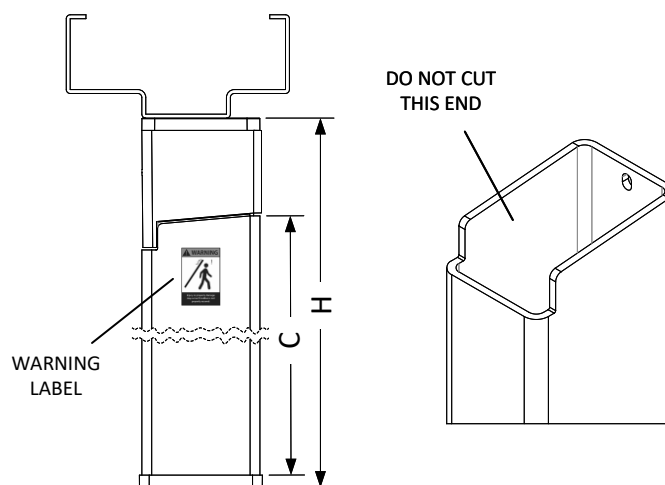

7. INSTALL BOTTOM BRACKET

- Place mullion on bottom bracket
- Close doors and slide into top bracket. Make mullion flush with the doors
- Verify centering notches align with marked center in Step 3
- Carefully remove mullion. Mark and drill (2) 3/8" holes 2" deep
- Secure bottom bracket using 3" anchors

8. ADJUST AND TEST FUNCTION

- If gap between mullion and top bracket is greater than 1/8" install template as shim above top bracket
- Adjust set screw CCW until mullion does not rattle
- Verify mullion is released when key is turned

