

Grade 2 Heavy Duty Deadbolt

1. Mark Door

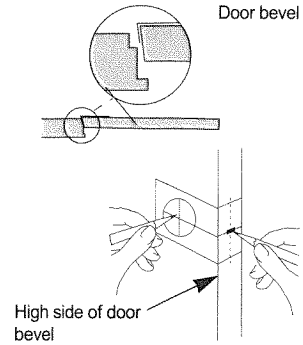

- Check lock for proper backset before marking.
- Fold template over door edge.
- Mark center for $2\frac{1}{8}$ " (54mm) hole.
- Mark center for 1 " (25mm) diameter latch hole in door edge.

2. Drill holes

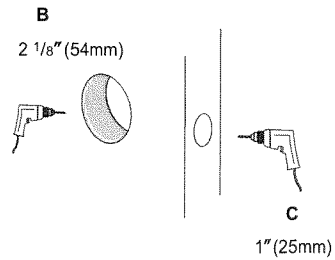

- Determine backset ($2\frac{3}{4}$ " or $2\frac{3}{8}$ " of the lock).
- Drill a $2\frac{1}{8}$ " (54mm) hole through both sides of the door as shown.
- Drill a 1 " (25mm) hole into front face of the door. Be certain holes are perpendicular.

3. Install Dead Bolt

Adjustable deadbolt is factory preset $2\frac{3}{4}$ " (70mm) backset.

- Bolt must be retracted. Retract deadbolt (if necessary, use screwdriver to turn cam and retract bolt).

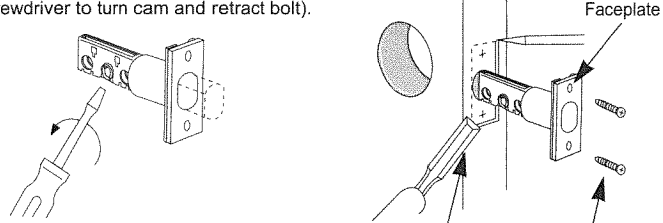

- How to adjust for $2\frac{3}{8}$ " (60mm) backset.

NOTE: Press on the bolt with thumb. Rotate faceplate and push down to move housing to next position.

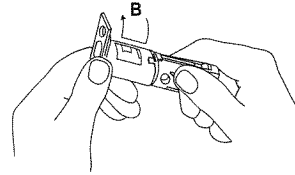

- Scribe line around faceplate.
- Chisel out scribed area to depth of $\frac{5}{32}$ " (4mm) or until face is flush with door edge.
- Insert deadbolt and fasten with two screws.

4. Prepare Door Jamb

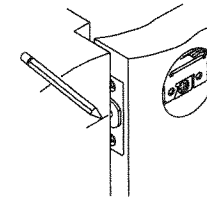

Note: Close door to mark horizontal center line of strike.

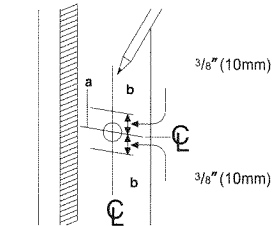

- Locate exact centerline of bolt and mark centerline on jamb.
- Mark drill points $\frac{3}{8}$ " (10mm) above and below centerline.

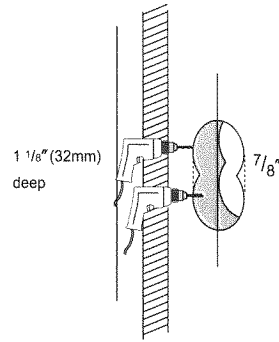

- Drill two overlapping $\frac{7}{8}$ " (22mm) $\frac{3}{8}$ " (10mm) above and below centerline to a depth of $1\frac{1}{8}$ " (32mm).

5. Install Strike

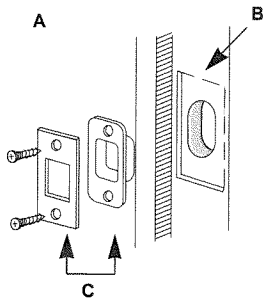

- Place strike box in hole. Place strike over the strike box and use it as pattern for cutout.
- Chisel about $\frac{1}{8}$ " (3.2mm) deep for flush fit of box and strike.
- Install strike box and strike with combi screws.

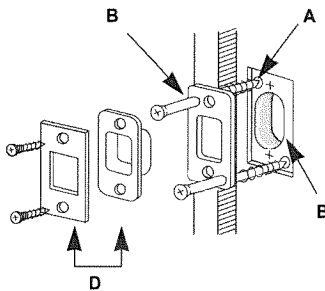

- Place reinforcer over holes with screw holes as shown. Mark and drill $\frac{3}{16}$ " (5mm) holes for reinforcement screws.
- Chisel about $\frac{1}{4}$ " (6mm) deep for flush fit of reinforcer, box and strike.
- Install Reinforcer with 3 " (76mm) wood screws.
- Install strike box and strike with combi screws.

6. Install Single Cylinder

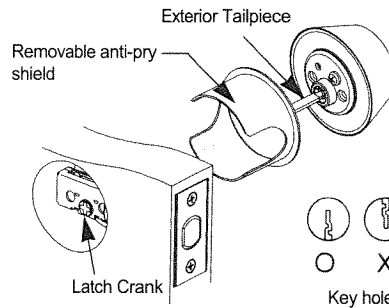

- Retract deadbolt to unlock position.
- Insert exterior tailpiece horizontally through latch crank.
- Press cylinder against door.
- Place inside turn piece assembly and tighten installation screws.

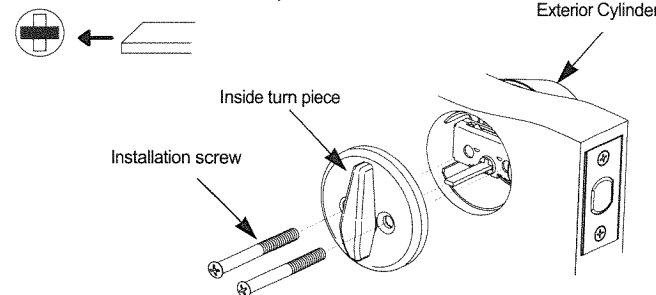

7. Install Double Cylinder

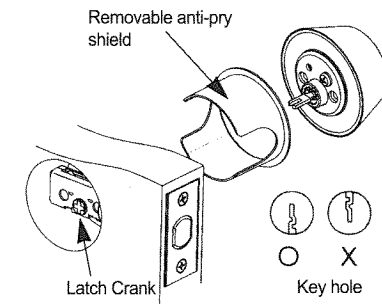

- Retract deadbolt to unlock.
- Insert exterior tailpiece through latch crank.
- Press exterior cylinder flus door.
- Insert interior tailpiece through latch crank.
- Press interior cylinder flus door and tighten installation.

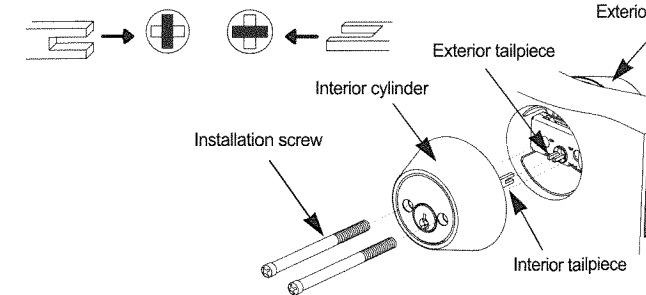

INSTALL THUMB TURN AND INDICATOR ASSEMBLIES

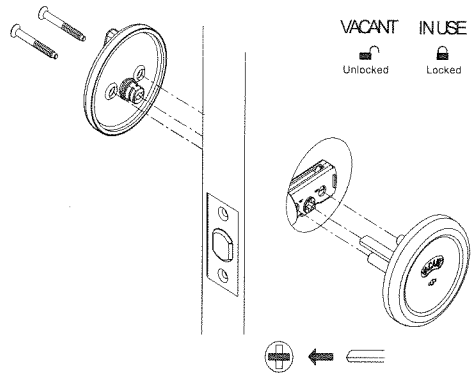

- With the deadbolt latch in the retracted position.
- Rotate the tailpiece of the indicator assembly to the horizontal position (unlocked).
- Insert the tailpiece through the deadbolt latch and hold the indicator assembly flush with the surface of the door.
- Install the thumb turn assembly by rotating the thumb turn in the vertical position and slide the thumb turn assembly over the tailpiece of the indicator assembly.
- Insert mounting screws into the thumb turn assembly, through the deadbolt latch and into the threaded posts on the indicator assembly.
- Tighten screws until the thumb turn and indicator assemblies are tight against the door.

CAUTION FOR CLASSROOM FUNCTION

- Check handing of lock installation (RH or LH).
- Insert the cam with Point upward into thumbturn piece.

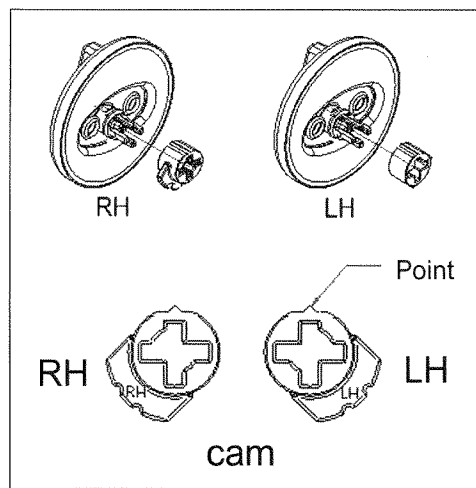
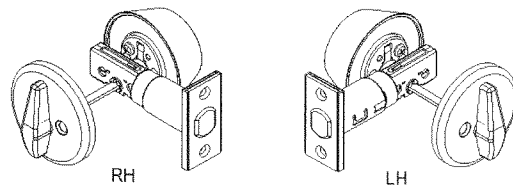

Small Format Interchangeable Core(Optional)

- Align driver as shown below.
- Core Installation : turn control key clockwise, then insert core into deadlock.
Turn control key back to vertical position and remove it from the core.
Test operation with user key.

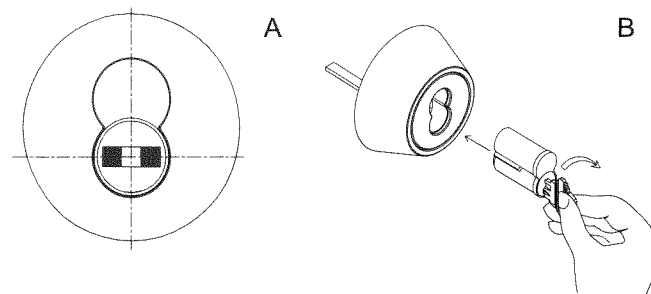

※ Adapter Ring (Thin Door Kit)

To install on 1-3/8" door, use optional adapter ring.

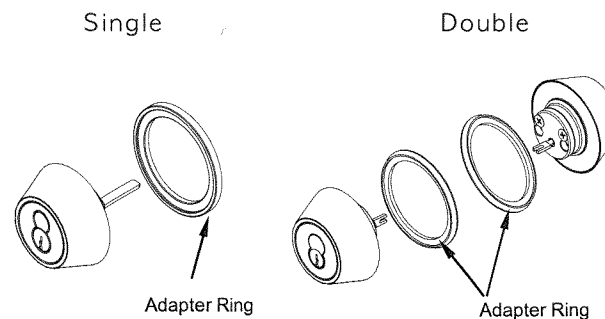

Large Format Interchangeable Co

- Align driver as shown below.
- Core Installation : turn control key clockwise, then insert core into deadlock.
Turn control key back to vertical position and remove it from the core.
Test operation with user key.

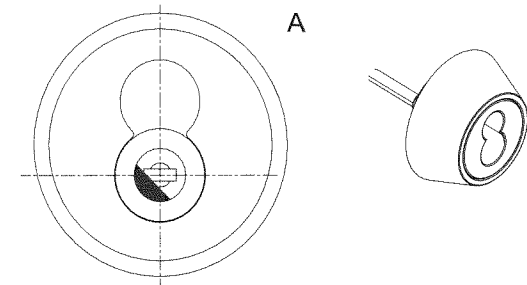

※ Adapter Ring (Thin Door Kit)

To install on 1-3/8" door, use optional adapter ring.

