



# MJ SERIES MORTISE DEADBOLT Installation Instructions

PDQ Industries  
2754 Creek Hill Road  
Leola, PA 17540  
1-800-441-9692  
Fax: 717-656-6892  
Web: [www.pdqlocks.com](http://www.pdqlocks.com)

**READ INSTRUCTIONS THOROUGHLY BEFORE INSTALLATION.** Accurate door preparation is essential for proper alignment and functioning of this lock. Follow template and instructions carefully to avoid installation problems.

**MJ132 – Deadbolt operation by key outside and turnpiece inside.**

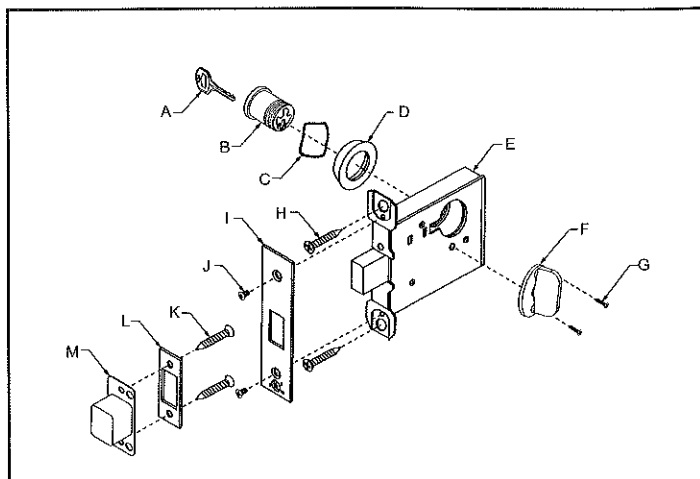

**MJ134 – Deadbolt operation by key outside, mortise cylinder turn inside will retract deadbolt but will not project it.**

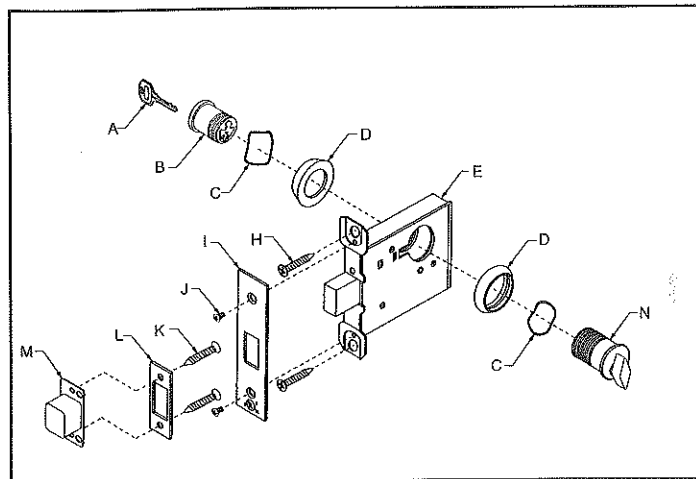

**MJ131 – Deadbolt operation by key outside.**

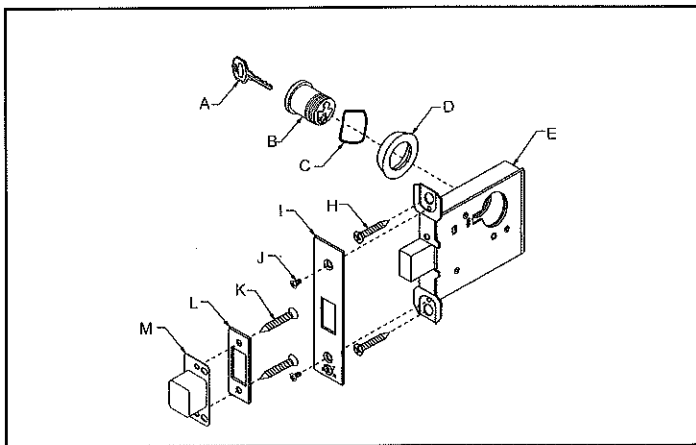

**MJ133 – Deadbolt operation by key outside and key inside.**

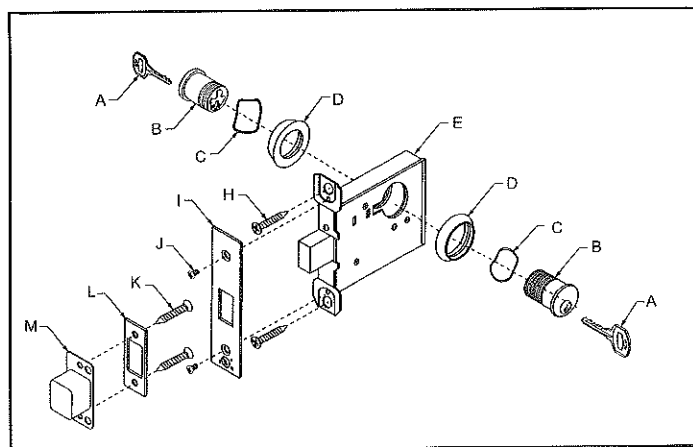

## Parts Name

A	Key	H	Chassis Mounting Screws
B	Mortise Cylinder	I	Armor Face Plate
C	Wave Spring	J	Face Plate Mounting Screws
D	Cylinder Collar	K	Strike Mounting Screws
E	Mortise Deadlock Chassis	L	Strike
F	Turnpiece Assembly	M	Dust Box
G	Turnpiece Mounting Screws	N	Thumbturn Cylinder

# A. DOOR AND JAMB PREPARATION

## 1. Mark horizontal line

Measure desired height from finished floor, mark a horizontal line on both sides and edge of door.

04911 A4-1000  
 5100-743-000-7  
 5000-000-117 X-7  
 www.lockbody.com

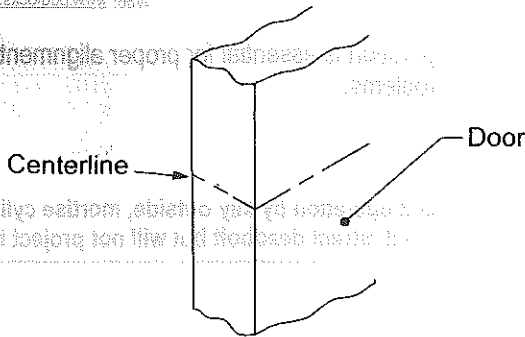

## 2. Mark drill points

Align template on edge of door with applicable horizontal at height line. Mark position of holes for appropriate lock function per "Holes to Drill" chart below.

**CAUTION:** Outside and inside of door may require different preparation. Use proper template for outside (exterior or corridor side) and for inside of door.

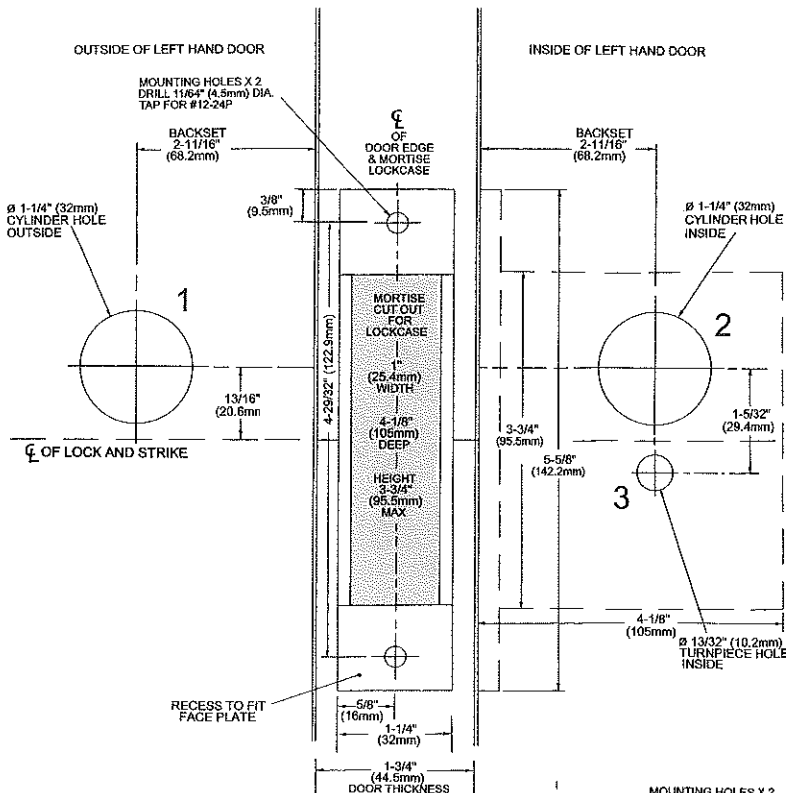

HOLES TO DRILL			
FUNCTION	1	2	3
MJ132	●		●
MJ133 MJ134	●	●	
MJ131	●		

**NOTE:**  
 The shadowy portions on both lock case & strike templates are suitable for metal door preparation.

## 3. Mortise door edge 1" (25.4 mm) drill, 4 1/8" (105 mm) deep by 4 1/4" (108 mm) high - for wood door only

- A. Align template with centerline of door edge and locate on centerline of lock case, or cylinder hole when applicable.
- B. For through holes (through face of door), drill halfway from each side of door to prevent splintering or otherwise damaging door.

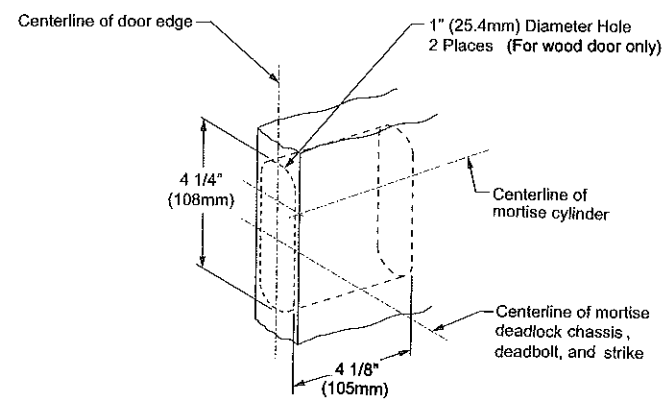

## 4. Recess for armor face plate

Recess to dimensions of armor face plate, the standard is : 1 1/4" (32mm) wide x 5 5/8" (142.2mm) high x 7/32" (5.6mm) deep.

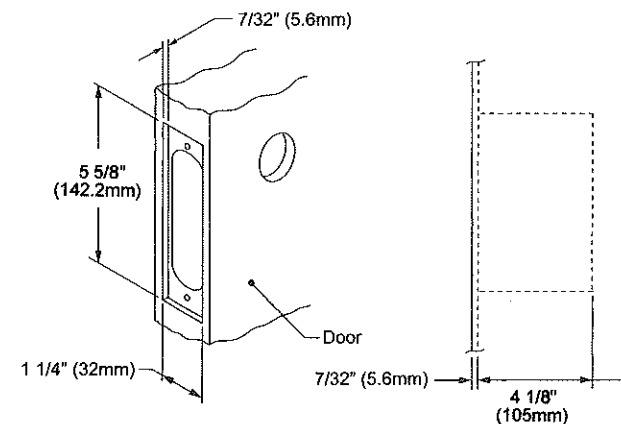

## 5. Strike installation

Align strike template on jamb. Be sure to match centerline on both strike and door templates. Mark strike outline on jamb, and mark outline of bolt opening. Bore 1" (25.4mm) diameter hole at center of bolt opening as shown, 1 3/16" (30mm) deep. Then chisel and recess 5/32" (4mm) deep to accommodate strike and dust box.

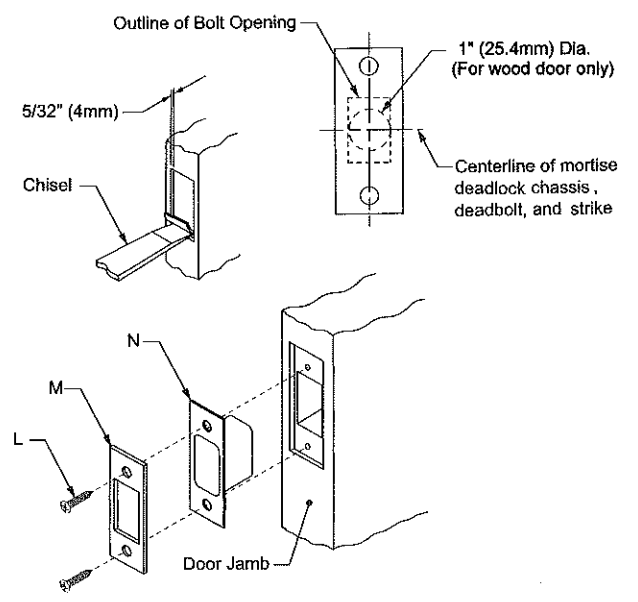

## B. LOCK INSTALLATION

### B-1 Install mortise deadlock chassis (lock case)

Insert lock case into mortise cutout (armor face plate removed) and fasten to door using two chassis mounting screws.

**NOTE :** Leave screws slightly loose to allow for adjustment in cylinder anchoring step.

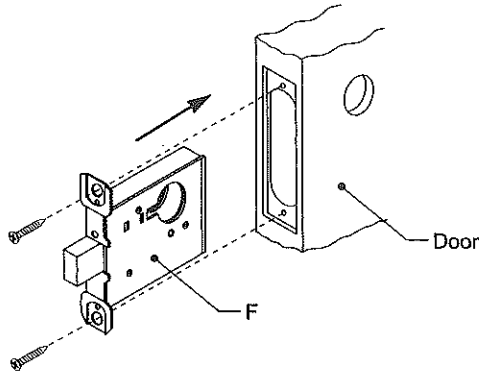

### MJ132 – Deadbolt operation by key outside and turnpiece inside

#### 1. Install mortise cylinder

Place wave spring and cylinder collar onto mortise cylinder. Screw mortise cylinder into lock case.

#### 2. Install turnpiece assembly

Place turnpiece assembly into lock case. Install turnpiece mounting screws into the door.

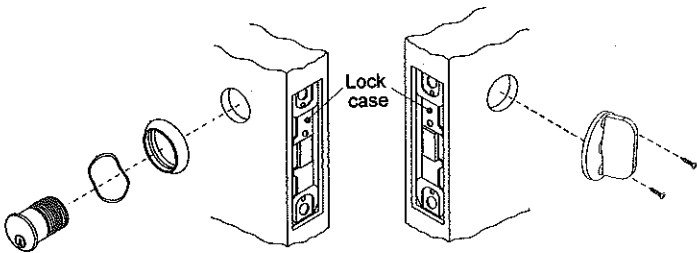

### MJ134 – Deadbolt operation by key outside, mortise cylinder turn inside will retract deadbolt but will not project it

#### 1. Install mortise cylinder

Place wave spring and cylinder collar onto mortise cylinder. Screw mortise cylinder into lock case.

#### 2. Install mortise cylinder turn

Place wave spring and cylinder collar onto mortise cylinder turn. Screw mortise cylinder turn into lock case.

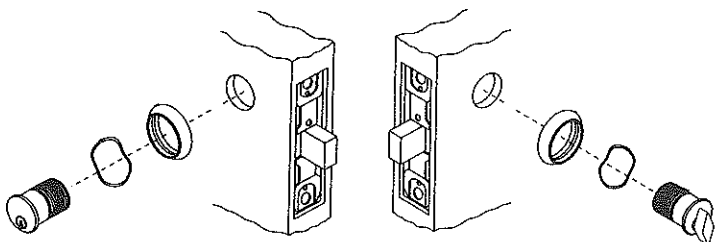

### MJ131 – Deadbolt operation by key outside

#### Install mortise cylinder

Place wave spring and cylinder collar onto mortise cylinder. Screw mortise cylinder into lock case.

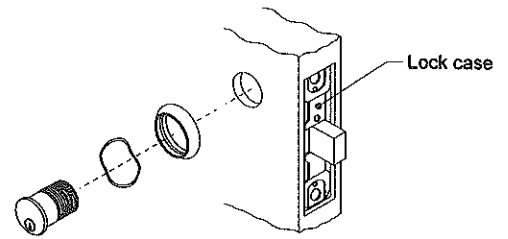

### MJ133 – Deadbolt operation by key outside and key inside

#### 1. Install mortise cylinder

Place wave spring and cylinder collar onto mortise cylinder. Screw mortise cylinder into lock case.

#### 2. Repeat procedure for opposite side.

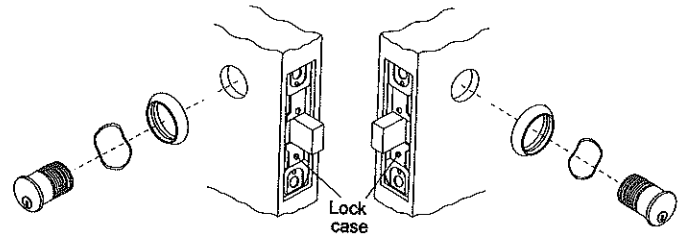

### B-2 Anchor mortise cylinder and install armor face plate

1. Rotate mortise cylinder until keyway is positioned vertically, as shown. When inserting key into mortise cylinder, key cuts should be up, not down. Tighten cylinder screw to lock mortise cylinder in place to prevent rotation or unauthorized removal.
2. Tighten two chassis mounting screws.
3. Place armor face plate in position on door and secure with two face plate mounting screws.

