

SECTIONAL LEVER AND BALL KNOB TRIM

TEMPLATE: W53515, REV. 4 3-27-2013

INSIDE OF RIGHT HAND DOOR

DOOR EDGE

OUTSIDE OF RIGHT HAND DOOR

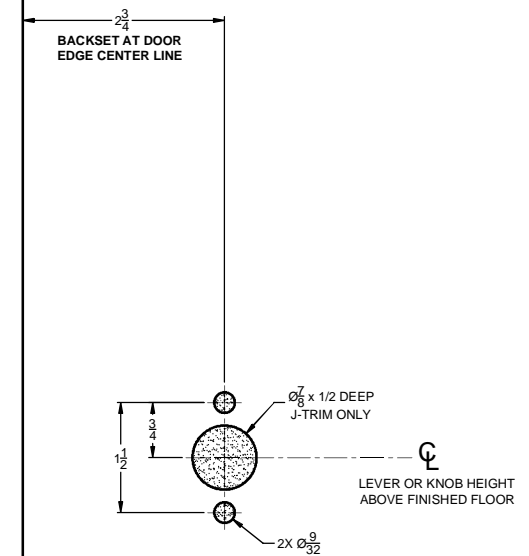
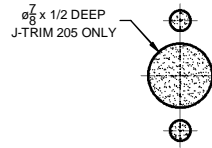

ANSI STANDARD:

MR SERIES MORTISE LOCKS ARE INSTALLED FOLLOWING THE DOOR AND FRAME REQUIREMENTS FOUND IN ANSI/BHMA A156.13-2002.

DOORS:

REINFORCEMENT IS REQUIRED PER ANSI A115.1-1991.

DOOR THICKNESS:

STANDARD DOOR THICKNESS IS 1-3/4". CONSULT FACTORY FOR OTHER DOOR SIZES.

LEAD LINING:

ADD 1/8" TO MORTISE WIDTH WHEN PREPARING DOOR FOR A LEAD LINED MR SERIES MORTISE LOCK BODY.

SILENCERS AND WEATHER STRIPPING:

PROVISIONS MUST BE MADE TO ALLOW PROPER DOOR CLOSURE WHEN USING DOOR SILENCERS, WEATHER STRIPPING OR SOUND PROOFING.

NOT TO SCALE



2754 CREEK HILL ROAD
LEOLA, PA 17540

PHONE: (800) 441-9692
FAX: (717) 656-6892

MR205 MR211

JOB: _____

DATE: _____

COMMENTS: _____